

Chestnut Close Ventnor, PO38 1DQ

£215,000



This 3 bedroom end of terraced house is located on the outskirts of Ventnor, within walking distance to local schools, shops & walk trails over Ventnor downs. The property consists of a kitchen, spacious lounge/dining area, Downstairs storage cupboard, two double bedrooms, one single bedroom & wet room. Other benefits of the property includes driveway for one vehicle, cul-de-sac location, stunning views over Ventnor downs & Gas central heating. This is the perfect property for first time buyers!!

END OF TERRACE

DRIVEWAY

CLOSE TO LOCAL SCHOOLS, SHOPS & BUS
STOPS

3 BEDROOMS

VIEWS OF VENTNOR DOWNS

GAS CENTRAL HEATING

ROOMS

Hallway

Kitchen 8' 6" x 9' 2" (2.6m x 2.8m)

Non-slip flooring. Fitted-kitchen with electric hob & oven. Sink drainer and room for white goods. Single glazed window to front aspect.

Lounge/Diner 15' 1" x 15' 5" (4.6m x 4.7m)

Wooden flooring. Double glazed window and door to rear aspect leading onto patio area. Radiator. Cupboard.

First Floor Landing

Bedroom 1 8' 10" x 5' 11" (2.7m x 1.8m)

Carpet flooring. Wardrobe space. Single glazed window to rear aspect. Radiator.

Bedroom 2 12' 2" x 9' 2" (3.7m x 2.8m)

Carpet flooring. Single glazed window to rear aspect. Radiator.

Bedroom 3 10' 10" x 9' 2" (3.3m x 2.8m)

Carpet flooring. Single glazed window to front aspect. Radiator.

Shower room 5' 7" x 5' 11" (1.7m x 1.8m)

Non-slip flooring. Walk-in shower, sink & WC. Single glazed window to front aspect. Heated towel rail. Cupboard to side aspect.

GROUND FLOOR

1ST FLOOR

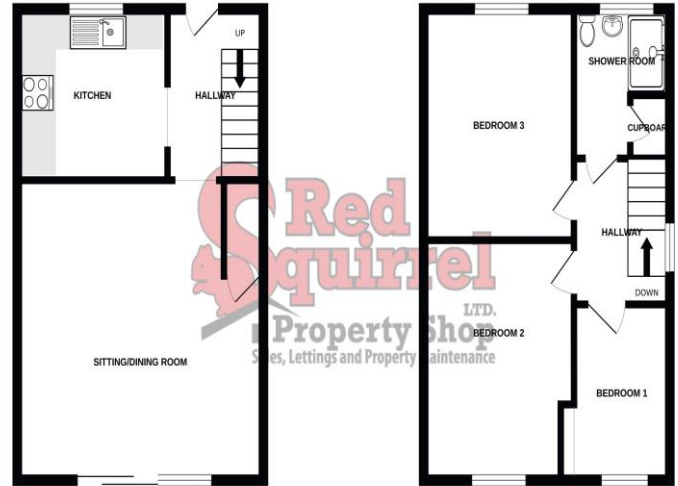

Whilst every attempt has been made to ensure the accuracy of the floorplan contained here, measurements of doors, windows, rooms and any other items are approximate and no responsibility is taken for any error, omission or mis-statement. This plan is for illustrative purposes only and should be used as such by any prospective purchaser. The services, systems and appliances shown have not been tested and no guarantee as to their operability or efficiency can be given.
Made with Metropix 12/21

